

Model 1667 Single Point Load Cells



type: single point (off center) load cell
material: aluminum alloy
surface: anodized treatment
protection: IP 65
certificate: OIML C3 (option)
application: platform scales

Suggested platform size:

50~200kg: 600mm x 600mm
250~500kg: 600mm x 800mm
750~2000kg: 1200mm x 1200mm

Dimensions:

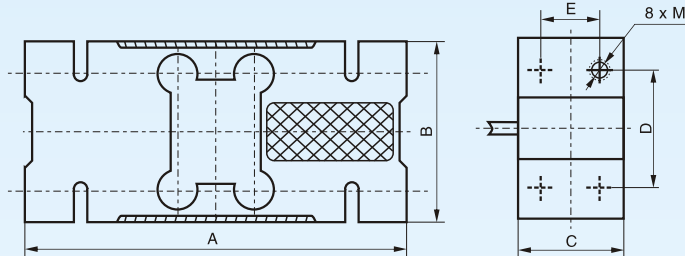

Electrical connection:

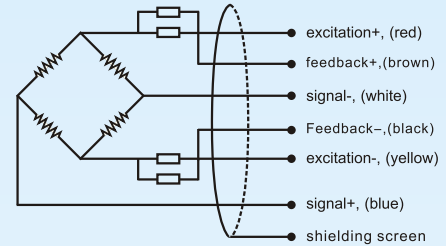

Capacity(kg)	A	B	C	D	E	M
50-200	156	75	44	50	24	M12-7H
300, 500	146	95	60	70	36	M12-7H
1000, 2000	176	125	76	95	46	M16-7H

Specifications:

capacity	kg	50, 100, 200, 300, 500, 1000, 2000
rated output	mV/V	2.0 ± 0.1
accuracy	%FSO	± 0.02 (option: OIML C3)
zero unbalance	%FSO	± 1.0
non-linearity	%FSO	± 0.02
hysteresis	%FSO	± 0.02
repeatability	%FSO	± 0.02
creep	%FSO/30min	± 0.02
temperature coefficient of SPAN	%FSO/10°C	0.02
temperature coefficient of ZERO	%FSO/10°C	0.02
input resistance	Ω	410 ± 10
output resistance	Ω	350 ± 10
insulation resistance	MΩ	≥ 5000 @ 50 VDC
excitation voltage	V	9~12 DC/AC
maximum excitation	V	6~18 DC/AC
compensated temperature range	°C	-10 ~ +40
operating temperature range	°C	-20 ~ +65
safe overload	%FS	150
ultimate overload	%FS	200
cable length	m, shielded PVC cable	3 (Φ6.2 mm 6-wire)

The listed specifications are subject to change without prior notice.

How to order: model - capacity - output - accuracy - IP rating - cable length - customer specific requests
ordering code example: 1667 - 200kg - 2mV/V - 0.02%fso - IP 65 - 3.5m - no specific requests

BCM SENSOR TECHNOLOGIES BVBA