

Model 4518/4598 Beam-type Load Cells

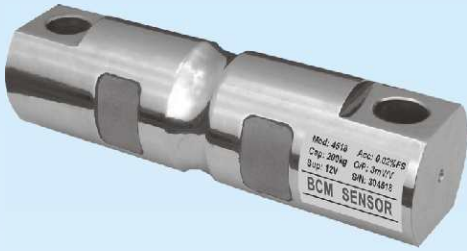

type: double-ended shear beam load cell
material: alloy steel (4518) / stainless steel (4598)
surface: nickel plated treatment (4518 only)
protection: IP 66
application: catalyst vessels, batching plant and truck weighers

Dimensions:

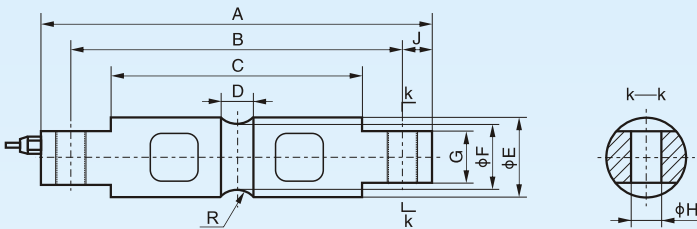

cap. (Klb)	A	B	C	D	E	F	G	H	J	R
5, 10	206.2	174.6	133.1	15.7	43.2	37.6	28.4	16.7	15.7	12.7
20	206.2	174.6	133.1	21.3	49.5	37.8	28.4	16.7	15.7	12.7
30-75	206.4	215.9	165.1	25.4	76.2	69.3	60.2	26.9	22.4	25.4
100	285.8	241.3	190.2	31.0	88.9	82.3	63.5	26.9	22.4	38.1
150	285.8	241.3	190.2	31.0	99.1	92.5	71.1	26.9	22.4	38.1
200-250	408.9	330.3	254.0	31.7	136.6	131.4	116.8	39.6	39.4	50.8

Electrical connection:

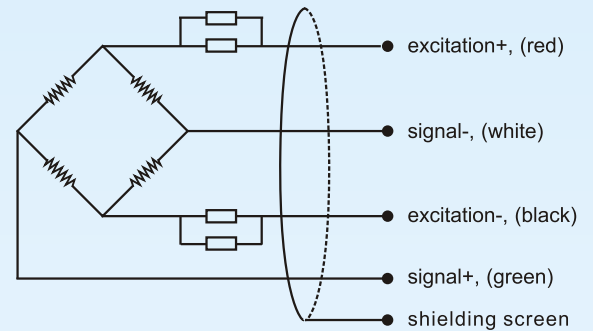

Specifications:

capacity	klb	5, 10, 20, 30, 50, 75, 100, 150, 200, 250
rated output	mV/V	3.0 ± 0.003
accuracy	%FSO	± 0.02
zero unbalance	%FSO	± 1.0
non-linearity	%FSO	± 0.02
hysteresis	%FSO	± 0.02
repeatability	%FSO	± 0.01
creep	%FSO/30min	± 0.02
temperature coefficient of SPAN	%FSO/10°C	0.02
temperature coefficient of ZERO	%FSO/10°C	0.02
input resistance	Ω	760 ± 30
output resistance	Ω	700 ± 10
insulation resistance	MΩ	≥ 5000@50 VDC
excitation recommended	V	9~12 DC/AC
maximum excitation	V	18 DC/AC
compensated temperature range	°C	-10 ~ +55
operating temperature range	°C	-35 ~ +65
safe overload	%FS	150
ultimate overload	%FS	200
cable length	m, shielded PVC cable	13 (Φ6 mm 4-wire)

The listed specifications are subject to change without prior notice.

How to order: model - capacity - output - accuracy - IP rating - cable length - customer specific requests
ordering code example: 4518 - 50klb - 3mV/V - 0.02%fso - IP 66 - 13m - no specific requests

BCM SENSOR TECHNOLOGIES BVBA